

A. Automatic antenna (except as of model year 92)

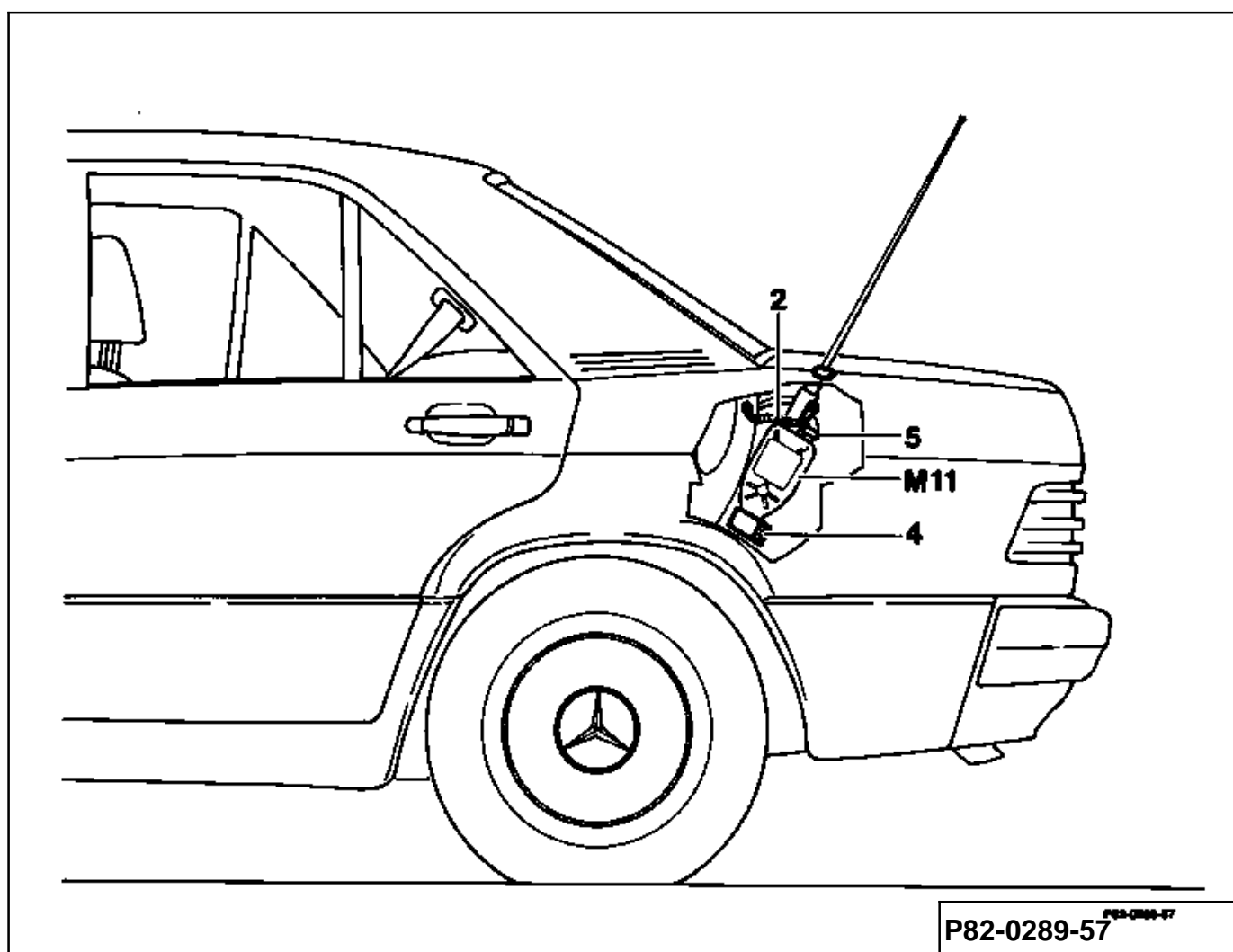

Ground cable at battery.....	disconnect, connect.
Cover in left wheelhouse.....	remove, install.
Electrical connection (5) and antenna cable.....	disconnect, connect.
Grounding strap (2) at strut.....	unscrew, screw on.
Mounting bracket (4) on inside of wheelhouse.....	unscrew, screw on.

Antenna (M11)..... pull down, insert from above.

Note

The antenna head is held in the wing by a rubber grommet.

From start of production, the antenna had an angle of inclination of approx. 10°.

Starting 05/87 the angle of inclination of the antenna has been approx. 30°.

Pay attention to the following points when removing and installing antenna:

1 The antenna head is held tight in the fender by a rubber grommet.

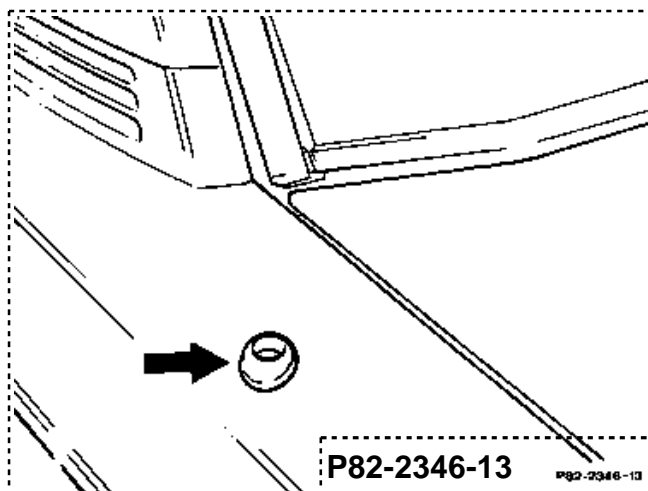

2 A grounding strap (2) creates the necessary connection to ground.

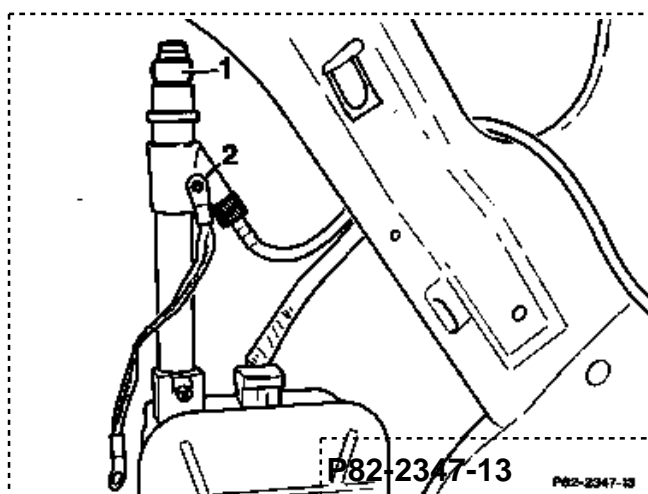

1 Antenna head

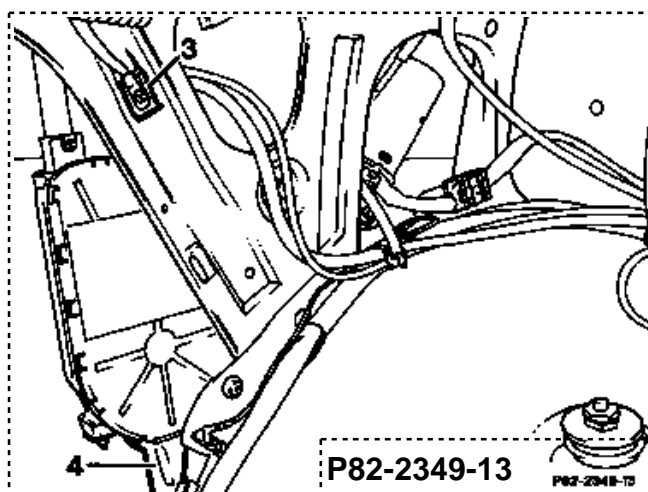

3 Grounding strap connection
4 Mounting bracket

3 Dimensions for making antenna hole in rear left fender.

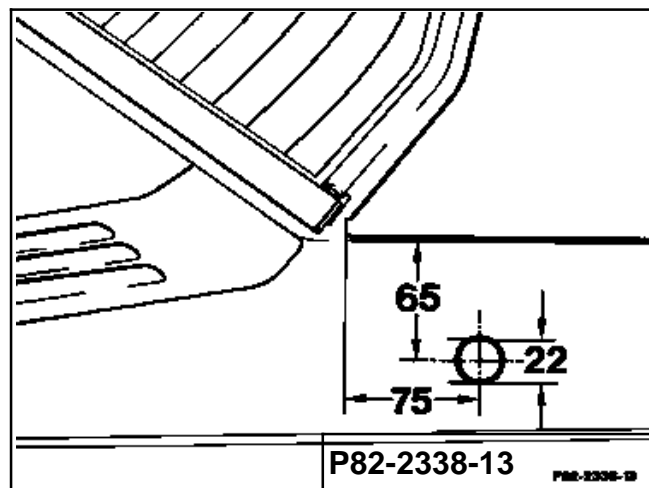

B. Arrangement of antenna model 201.036 Evolution II

Arrangement of antenna model 201.036 Evolution II

For space reasons, a short rod antenna is mounted on the roof. The antenna cable runs from the antenna to the C pillar on the left into the trunk and in the cable duct to front to the radio.

Repair instructions

In order to remove the antenna rod, the sleeve (arrow) must be pressed down and turned to the left (bayonet lock).

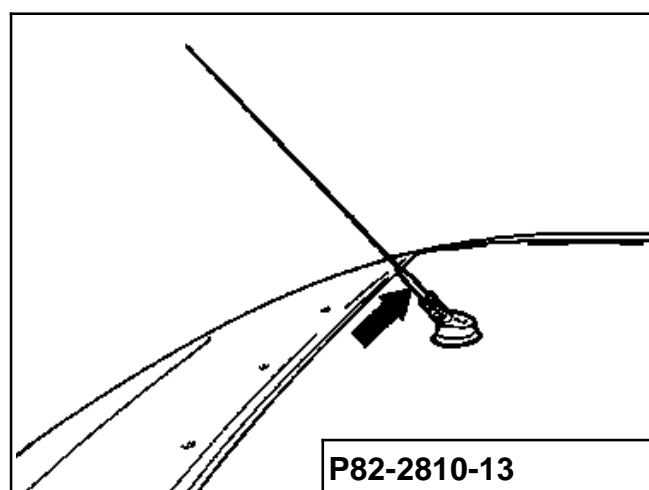

C. Removing and installing antenna (radio/telephone), (USA) as of model year 92

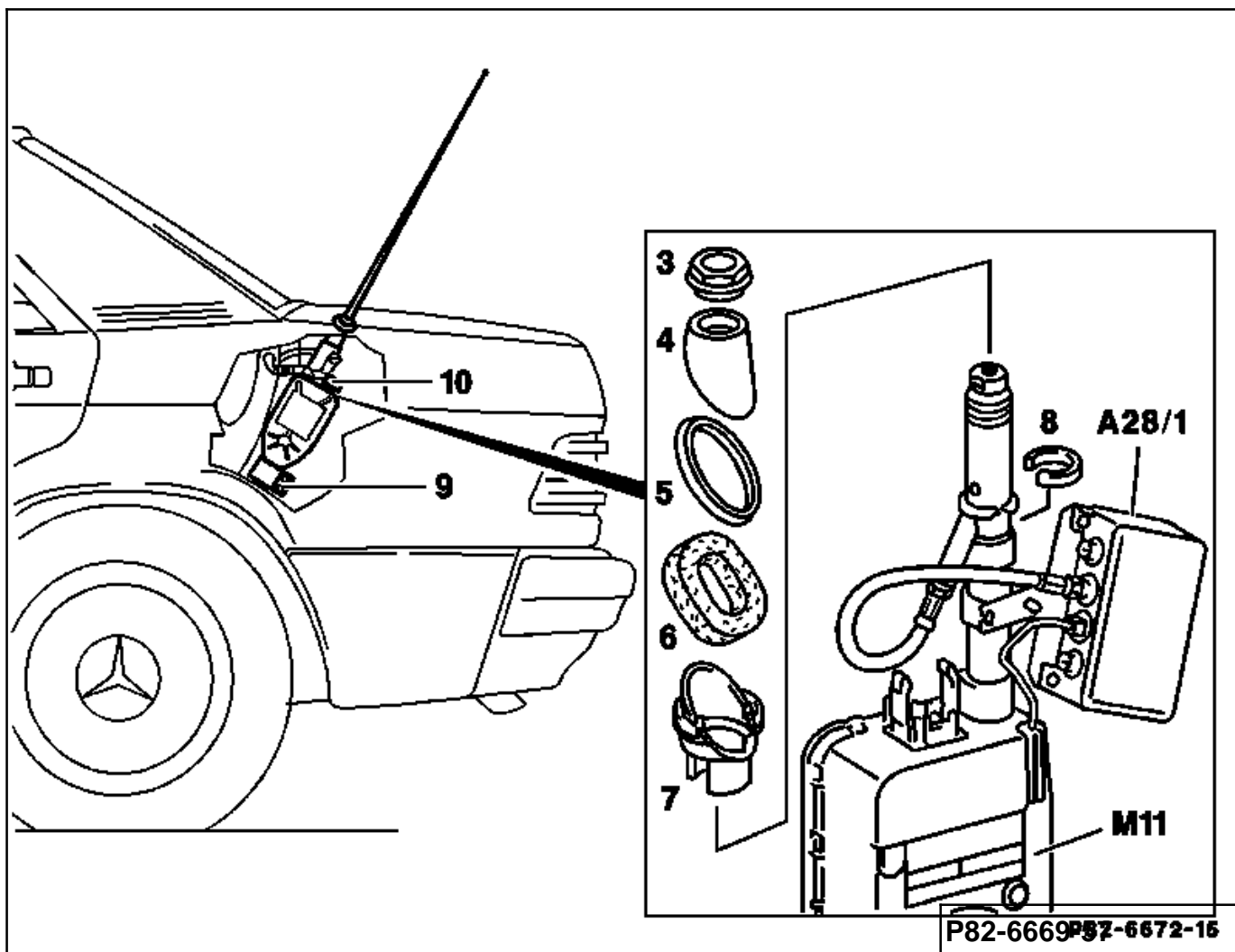

A28/1 Antenna splitter, electrical antenna
M11 Antenna
3 Nut
4 Cover
5 Sealing ring

6 Foam
7 Spacer
8 Plastic clip
9 Bracket
10 Electrical connection

Ground cable at battery.....	disconnect, connect.
Cover in left wheelhouse.....	remove, install.
Nut (3).....	unscrew, screw in.
Bracket (9).....	unbolt, bolt on.
Electrical connection (10).....	disconnect, connect.
Antenna cable for radio and telephone at antenna splitter (A28/1).....	disconnect, connect.
Antenna (M11).....	remove, insert.

Note

When installing antenna, ensure that good ground connection exists between antenna head and fender.